



Application for a Demolition Permit

4583 E Snow Road
PO Box 214
Berrien Springs, MI 49103
Phone: (269) 471-2824
Fax: (269) 471-2826

THIS FORM IS NOT A PERMIT: A demolition permit *will not* be issued until the information submitted on this form has been reviewed *AND* the gas, electric, and water utilities have provided verification of shut-off/disconnect.

INSURANCE REQUIREMENT: A copy of an insurance certificate naming Oronoko Charter Township as additional insured and indicating the location of the project i.e., street address, *must be attached to this form.*

DEMOLITION CONDITIONS: The following standard conditions apply:

- A. No structure shall be removed from the premises in a whole or substantially whole condition. All buildings shall be demolished on the premises.
- B. Water services into commercial structures shall be capped and staked at the lot line or at a location designated by the Inspector.
- C. The sewer lateral, *and storm lateral if one exists*, shall be exposed and properly capped at the lot line or at a location designated by the Inspector. **Backfilling is to be done only after inspected and approved by the Township.**
- D. All structures and their foundations shall be completely razed to a level of two (2) feet below the ground surface or grade line and removed from the site.
- E. Concrete floors shall be broken to allow water to drain from the site.
- F. All basements and cellars or other areas below grade shall be filled and compacted to grade only with sound approved solid fill.
- G. All masonry, such as private sidewalks, driveways, driveway aprons or retaining walls, shall be removed unless such removal will create a hazardous condition or unless the owner has requested otherwise in writing.
- H. Wood partitions, stairways, furnaces, piping and other equipment, rubbish and debris located in basements or elsewhere on the property shall be removed from the site.
- I. Demolition and disposal shall be compliant with Natural Resources and Environmental Protection Act, Public Act 451 of 1994 (as amended), Parts 55, 111 and 115 and adopted administrative rules and all ordinances adopted by Oronoko Charter Township.
- J. Any damage to public sidewalks or any part of the street right-of-way shall be repaired or replaced.
- K. The lot shall be filled, compacted and graded to blend with surrounding property and sidewalk grades.
- L. Final fill shall be at least two (2) inches of sandy loam, dirt or topsoil containing no brick, mortar or concrete pieces larger than two (2) inches.

Address: _____ **Perm Parcel No:** 11-15-_____-_____-_____-_____

I. Building Information

- A. Number of Building(s) to be Demolished: _____
- B. Will any buildings or structures remain? Yes No
If yes, explain: _____
- C. Residential Structure Nonresidential Structure (Commercial, Industrial, Institutional, etc.)
- D. Vacant Occupied
- E.1. Main Building Size: _____ x _____
- E.2. Number of Stories: _____
- F.1. Accessory Building Size _____ x _____
- F.2. Number of Stories: _____

For Office Use Only	
Work to be Done _____	Approved By _____
Use Group Code _____	Building Permit Fee - \$50.00
Building Permit Number _____	<input type="checkbox"/> Cash <input type="checkbox"/> Check # _____
Building Permit Issued _____	

II. Site Information

- A. Distance of the building(s) to be demolished from a water body (lake, river, stream, drainage ditch)? _____ feet
- B. Total area of grading required to restore the site: Less than 1 acre More than 1 acre
- C. Distance of building(s) to be demolished from the street right-of-way (ROW)? _____ feet
- D. Will the demolition work require barricading of the sidewalk or street? Yes No
- E. Is a site sketch attached, showing all structures and site dimensions? Yes No

III. Property History and Use Information *This section should be completed by the property owner*

- A. Previous/Current Use of Property: _____
- B. Reason for Demolition:
 - Township Demolition Orders Is this a Township Contract? Yes No
 - Other Reason Explain: _____
 - Has the demolition been reviewed and approved? Yes No
- C. Future Use of Property: _____
- D. Demolition Contract Cost: _____

IV. Applicant Information

- A. Property Owner (If property owner is Permit Applicant, Check Here)

Name _____	Business Phone _____
Company _____	Fax _____
Address _____	Mobile Phone _____
City, State, Zip _____	Email _____
- B. Contractor (If contractor is Permit Applicant, Check Here)

Name _____	Business Phone _____
Company _____	Fax _____
Address _____	Mobile Phone _____
City, State, Zip _____	Email _____
- C. Applicant Information (Signature Required, Contact Information Required if Applicant Not Indicated by a Check Box Above)

Name _____	Business Phone _____
Company _____	Fax _____
Address _____	Mobile Phone _____
City, State, Zip _____	Email _____

For Residential Demolitions Only:

Builders Lic No _____ Exp Date _____ Additional Contact Person _____

Federal Employer ID Number _____

If exempt, explain _____

MESC Employer Number _____

If exempt, explain _____

Workers Comp Insurance Carrier _____

If exempt, explain _____

IMPORTANT: "Section 23a of the State Construction Code Act of 1972, 1972 PA 230, MCL 125.1523a, prohibits a person from conspiring to circumvent the licensing requirements of this state relating to persons who are to perform work on a residential building or residential structure. Violators of Section 23a are subjected to civil fines."

Applicant Signature _____ Date _____

Driver's License No (Homeowner Permits Only) _____

WARNING: ANY OMISSION OR MISREPRESENTATION OF FACT ON THIS DOCUMENT MAY RESULT IN THE REVOCATIO OF THE BUILDING PERMIT AND/OR LEGAL ACTION BEING TAKEN



Sample

Demolition Site Sketch

THIS IS A SAMPLE: This page *may not* be submitted with a permit application. It is provided for illustrative purposes only. Do not attempt to markup, revise, or otherwise adapt this page to your project. The details shown on this sample are not exhaustive for all site plans; the site plan for your project may need to show details that are not included in the sample. If you have questions regarding the site plan requirements for a particular project, please contact Oronoko Township at (269) 471-2824.

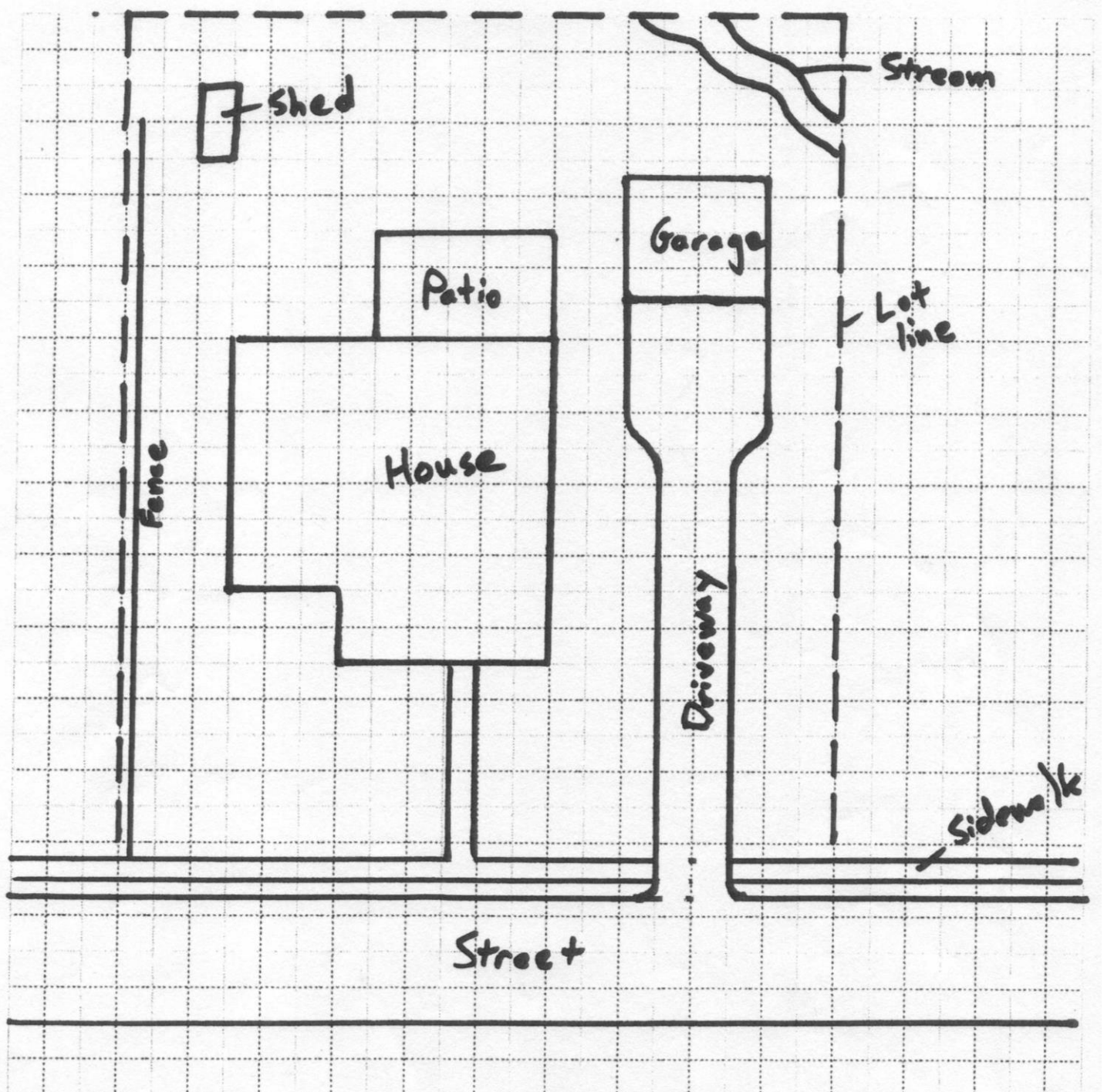

Address: 1234 Sample Dr. NW

Scale: Length of one (1) square = 10 feet